



**STEVEDORING, WAREHOUSING and PACKING SERVICES**



# Chimpex in a nutshell

- Market leader in port operations in Constanța since 1971
- One of the best strategic locations in the Port of Constanța with good access by road, rail and water.
- 360,000 sq.m. of operating area
- 10 operational berths (with a total quay length of 2.26 km)
- Water depth of up to 13.5 m
- 10 railway tracks and access for road transport
- Total covered storage capacity of 300.000 tons
- Total operating capacity – 4 million tons of commodities/year



loading • discharging • storing

# New grains terminal

**Total value of the investment:** around 44 million euros

**Constructions finalization:** 2017

**Location:** Mol IV Constanta Port, Berth 55

**Surface:** 2.18 hectares

**Depositing capacity** – 200,000 tons ( 20 silos of 10,000 tons capacity each)

**Operating capacity** – over 3.5 million tons of grains and oily plants per year (wheat, barley, corn, rape, sunflower)



loading • discharging • storing

# New grains terminal – seen from the South

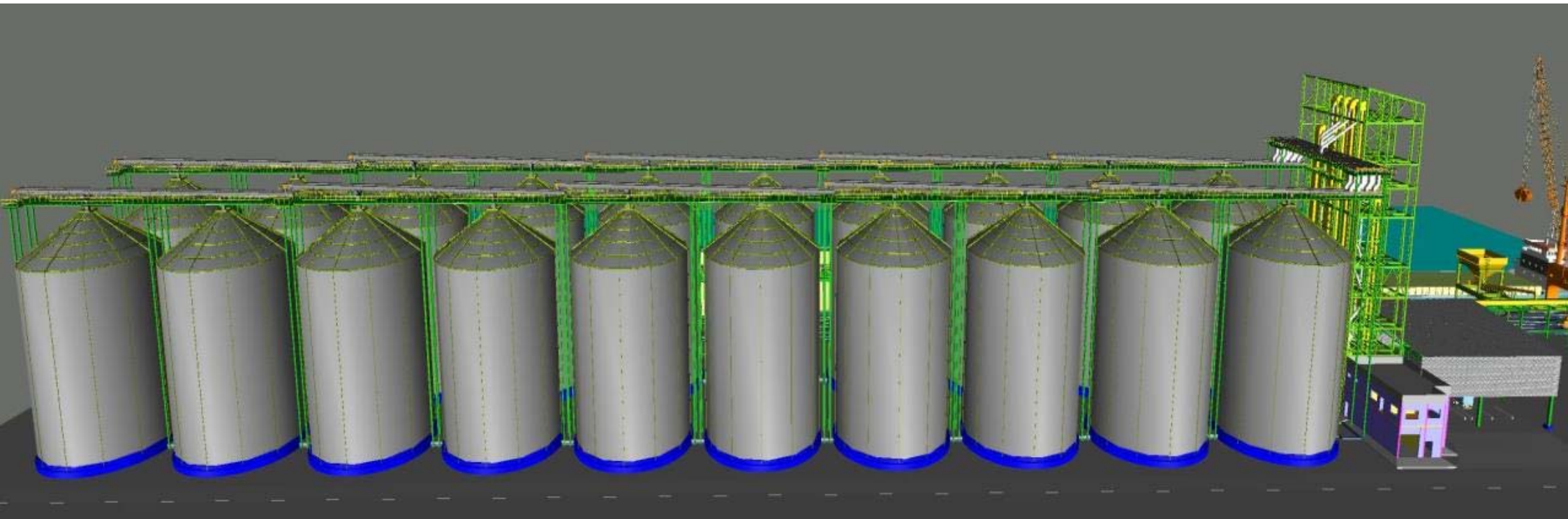

loading • discharging • storing

## New grains terminal

### Facilities:

- Ventilation and constant monitorization through a dedicated electromechanic system
- Adjusting when loading and unloading,
- Ecologic operating system, dust-free
- Direct transbordation from the means of transportation to the ship

### Technical features:

- Each compartment of the silo has a diameter of 24 meters and height of 34 meters and is made of steel
- Foundation: reinforced concrete on pillar structure
- Operation rate: 2 \* 800 tons /hour (for loading)

loading • discharging • storing



3D Model – Metal structure

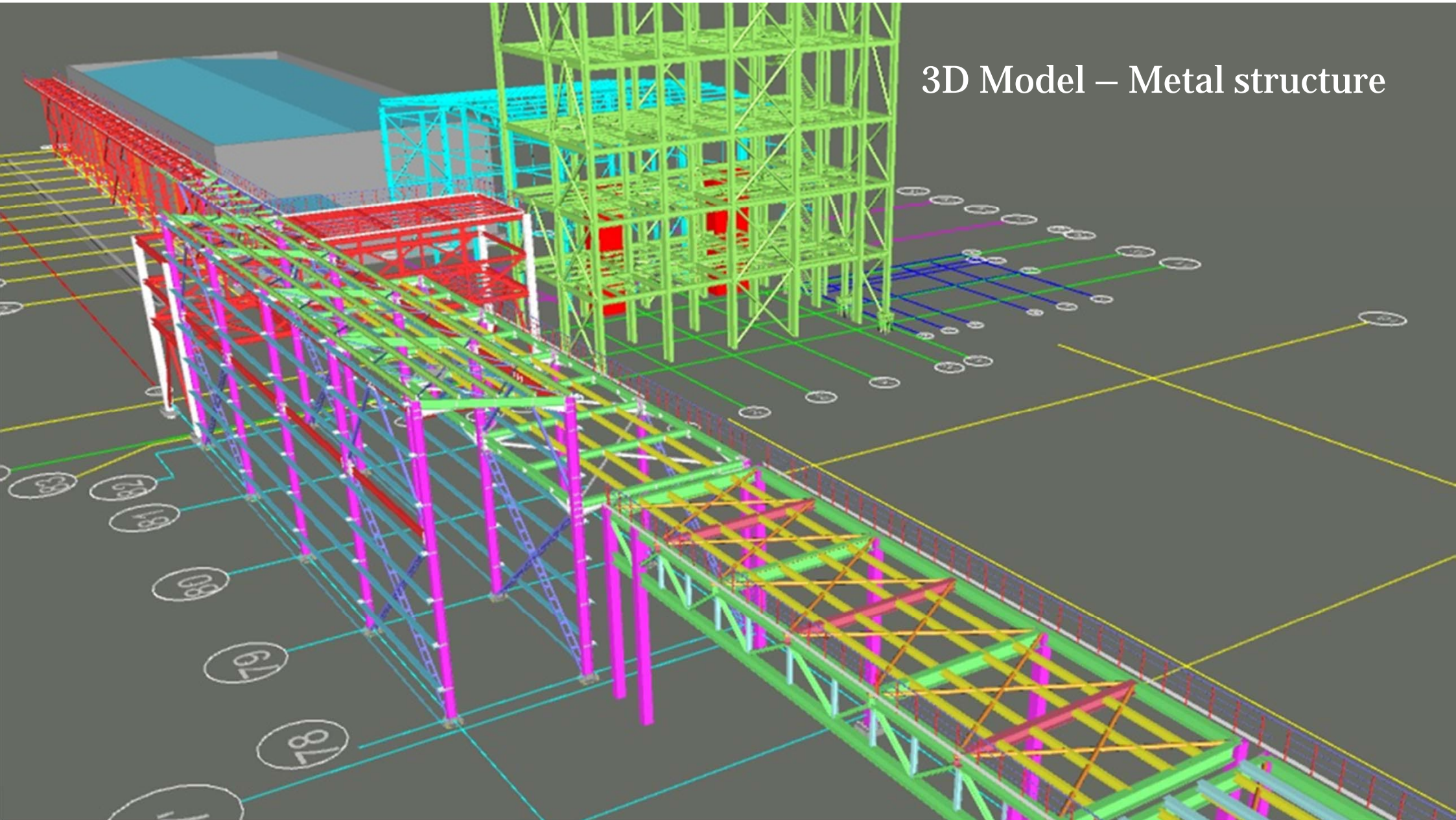

## New grains terminal

Most important benefits:

- + 60 % depositing capacity
- Makes loading and unloading operations more efficient
- Supplementary capacity of handling of minimum 3.5 million tons
- Ecologic operation system
- Assures top quality conditions and services



loading • discharging • storing

# Port of Constanta – increasing competitiveness

- Evolution of grains volumes and overall products' quantities that passed through Constanta Port in the past years:

Year	2007	2008	2009	2010	2011	2012	2013	2014	2015
Quantity of grains (mil. tons)	4.26	6.67	10.42	12.1	9.53	12.63	15.26	17.4	19.62
Total products' quant. (mil. tons)	57.78	61.84	42	47.56	46	50.59	55.14	55.64	56.34

Source: Report of CN APM Constanta

- Romania has growing perspective to intensify partnerships especially with non-European countries, based on increasing agriculture production

loading • discharging • storing





# Port of Constanta- competitiveness analysis

Resource	Rare	Valuable	Inimitable	Nonsubstitutable
Location	Yes	Yes	Yes	Yes
Infrastructure	No	Yes	No	Yes
Costs	Yes	Yes	Yes	Yes
In Port logistics	Yes	Yes	Yes	Yes
Merchandise safety	Yes	Yes	No	Yes
Port Management	Yes	Yes	No	Yes

loading • discharging • storing

# Port of Constanta- competitiveness analysis

Combined Resources	Rare	Valuable	Inimitable	Nonsubstitutable
Location, Infrastructure, Costs	Yes	Yes	yes	Yes

loading • discharging • storing



# Port of Constanta – increasing competitiveness

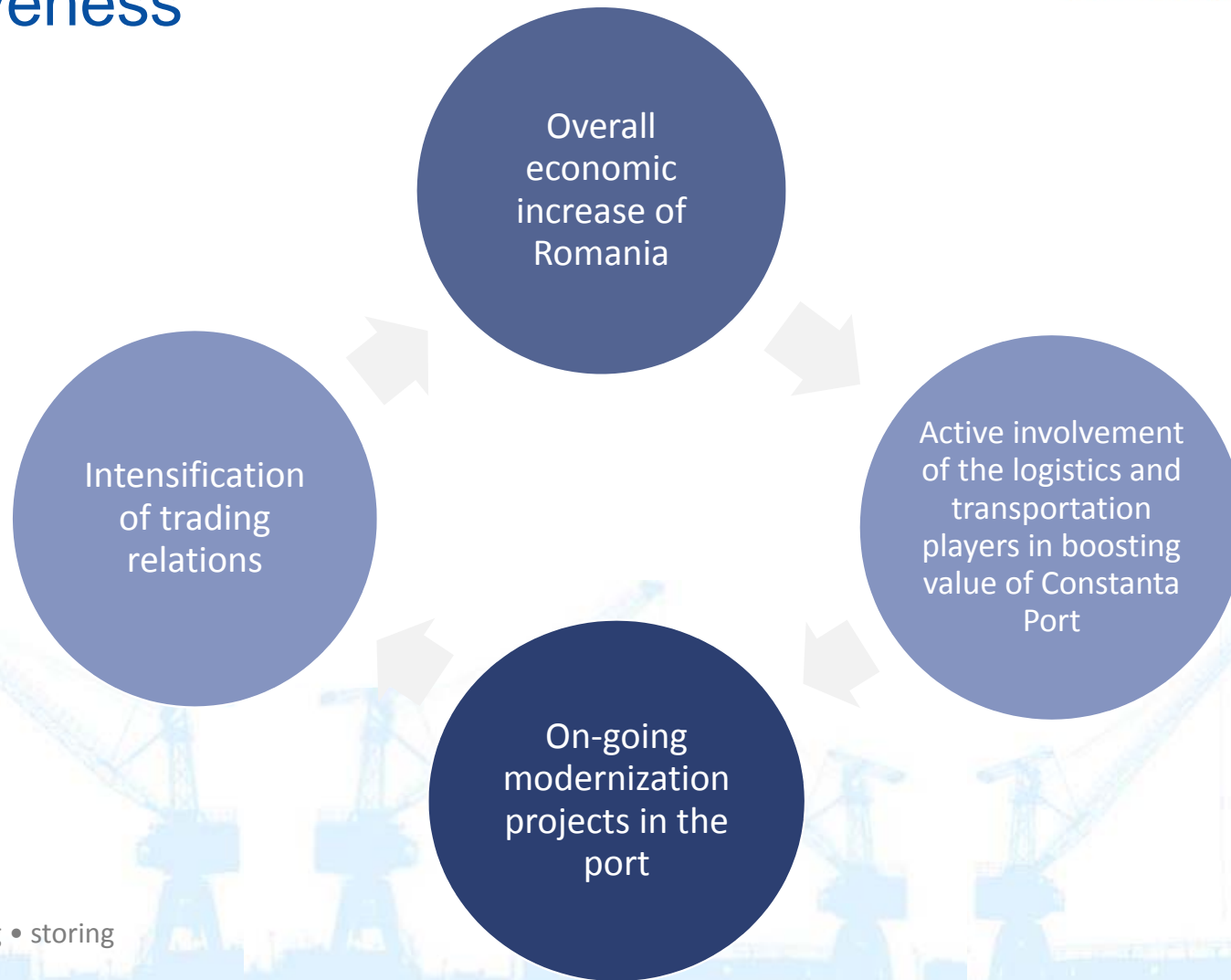

loading • discharging • storing



An Ameropa Company  
**CHIMP**  **X**  
trust and competence



Professionalism

Integrity

Top quality services



Innovation

Safety

Sustainability

Efficiency

loading • discharging • storing



With thanks,

