



## Brake Technology and Monitoring for Increasing Safety and Productivity

Lars Benner, Technical Sales



Siegerland Bremsen

### SIBRE Holding GmbH & Co KG

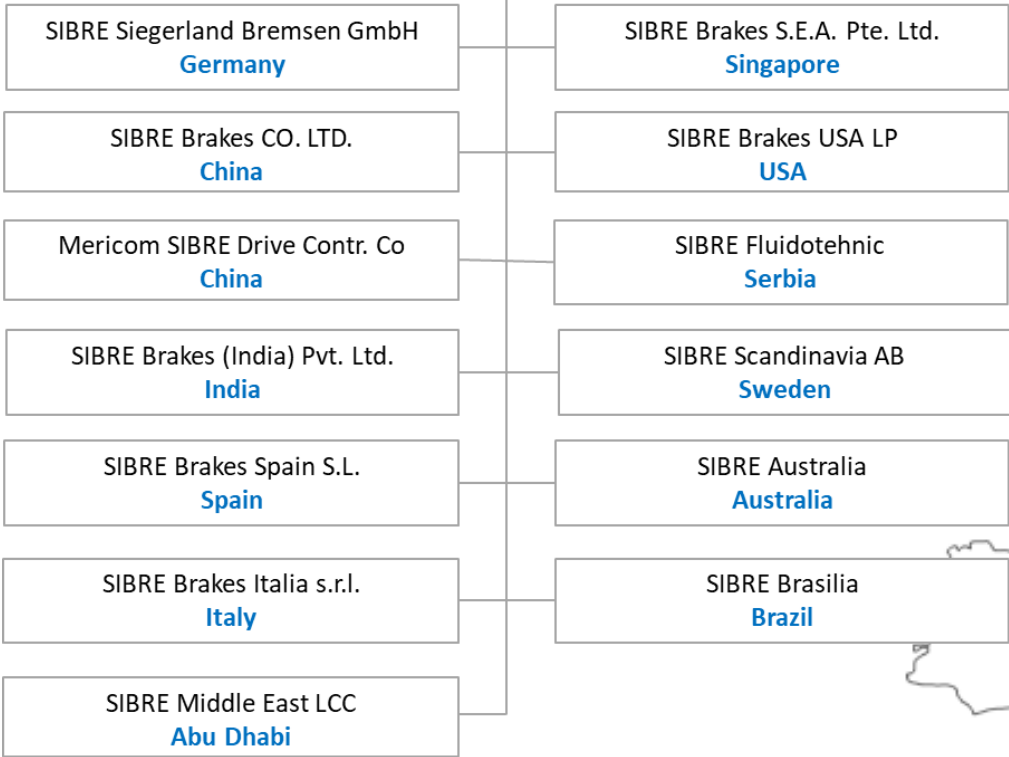

AS A ONE STOP SUPPLIER, SIBRE  
DELIVERES COMPREHENSIVE  
SOLUTIONS FOR ALL DRIVES IN CRANES.

SERVICE-BRAKES

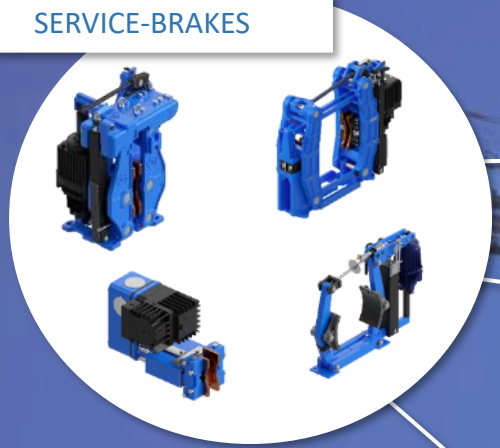

SAFETY-BRAKES

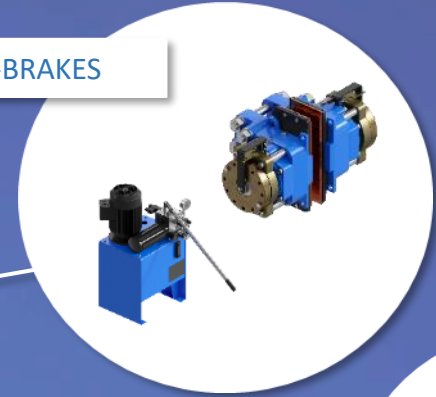

SNAG LOAD PROTECTION & MONITORING



STORM-BRAKES



WHEELS & SHEAVES

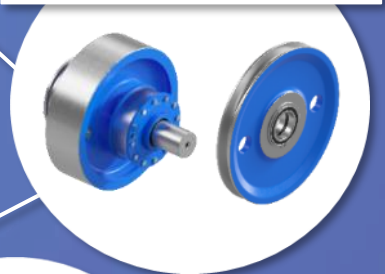

HYDRAULIC BUFFERS



COUPLINGS



# SIBRE invest to stay future-proof and reliable

- 3 new halls in total
- 18 new CNC machines + ABB handling robots
- > 17 Mio € investment since 2019
- Highest energy efficiency



# SIBRE invest to stay future-proof and reliable

- **Existing test rig**
  - Renewal of control, measurement and evaluation
- **Dynamic storm brake test rig**
  - Holding forces over 1000 kN
- **New dynamic test rig**
  - Inertia up to 500 kgm<sup>2</sup>
  - Speed up to 2200 rpm



# SIBRE new developments

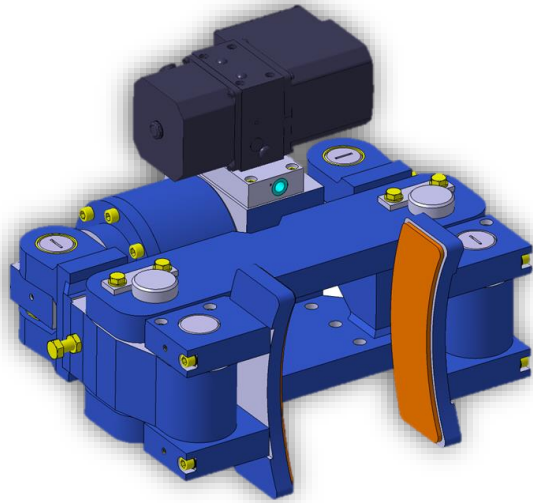

## **RHI face lift**

Casted version  
Braking forces up to 120 kN  
available with at side HPU

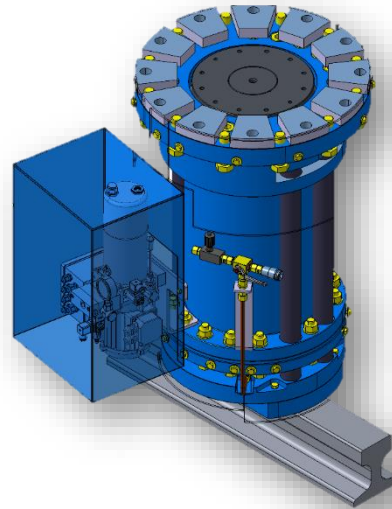

## **RPS with HPU at side**

No piping along the bogie  
Reduction of opening time

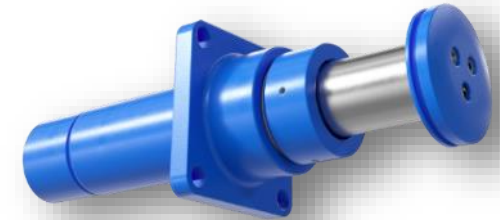

## **New buffer series SP**

Forces up to 700 kN  
Strokes up to 1200 mm

# USB5 service brake - key design advantages

- Designed for all applications in a crane
- Identical conditions regarding installation, adjustment and maintenance
- Enhanced corrosion protection
- Parallel opening of brake shoes
- Optimized spring unit
- Upgraded manual release system
- Monitoring of brake status

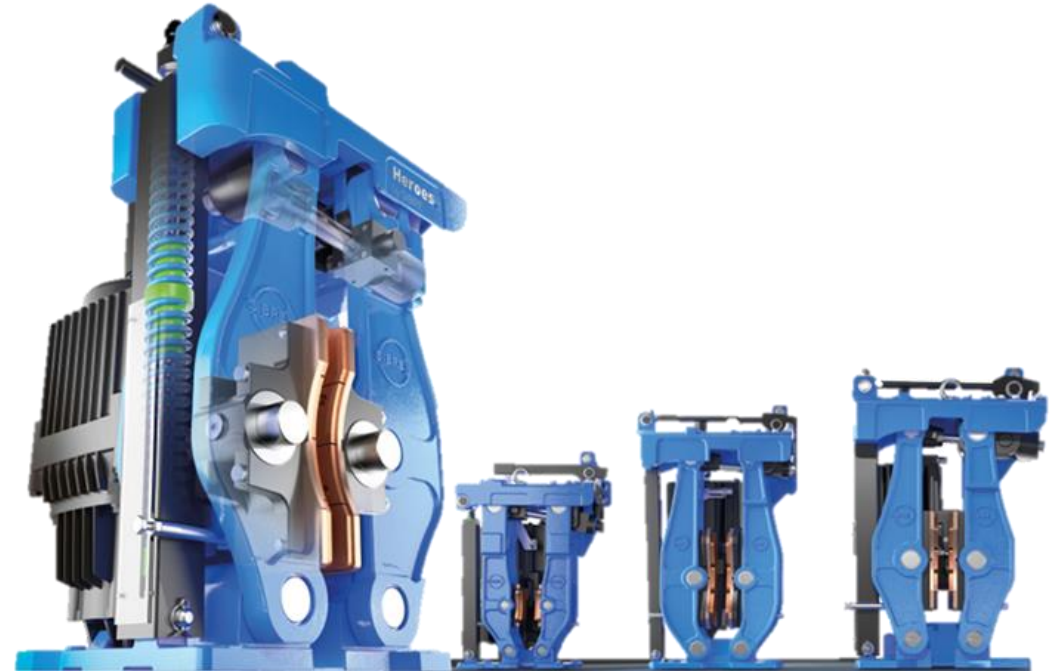

# SHI emergency brake

- Standardized functional principle, available in 7 different sizes
- Clamping force range: 17kN - 555kN
- Less leakage-risk
- Less maintenance requirements
- Favorable force-transmission

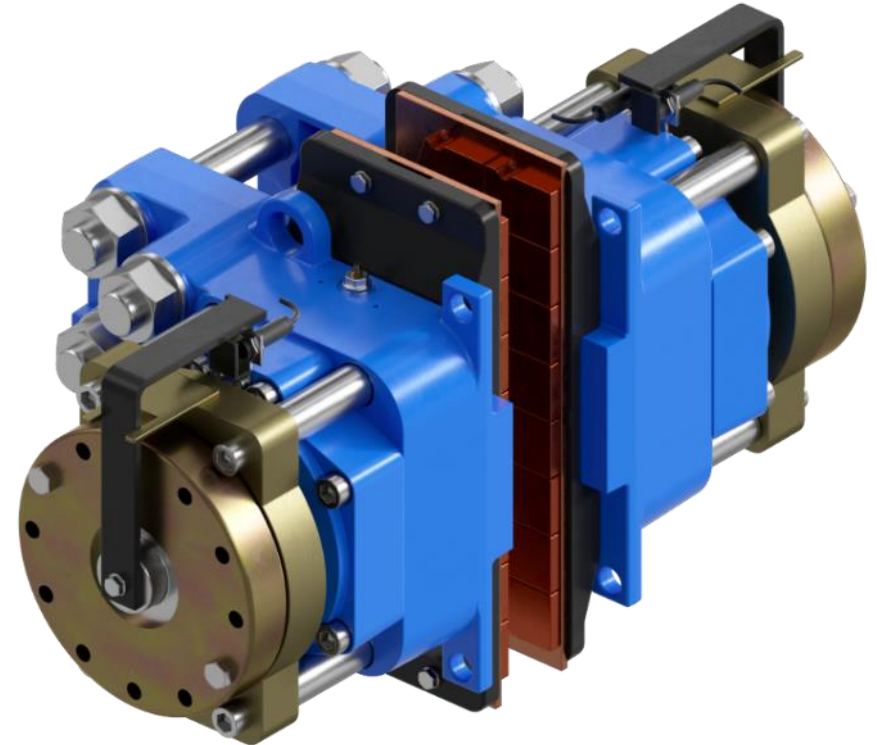



# SHI design benefits

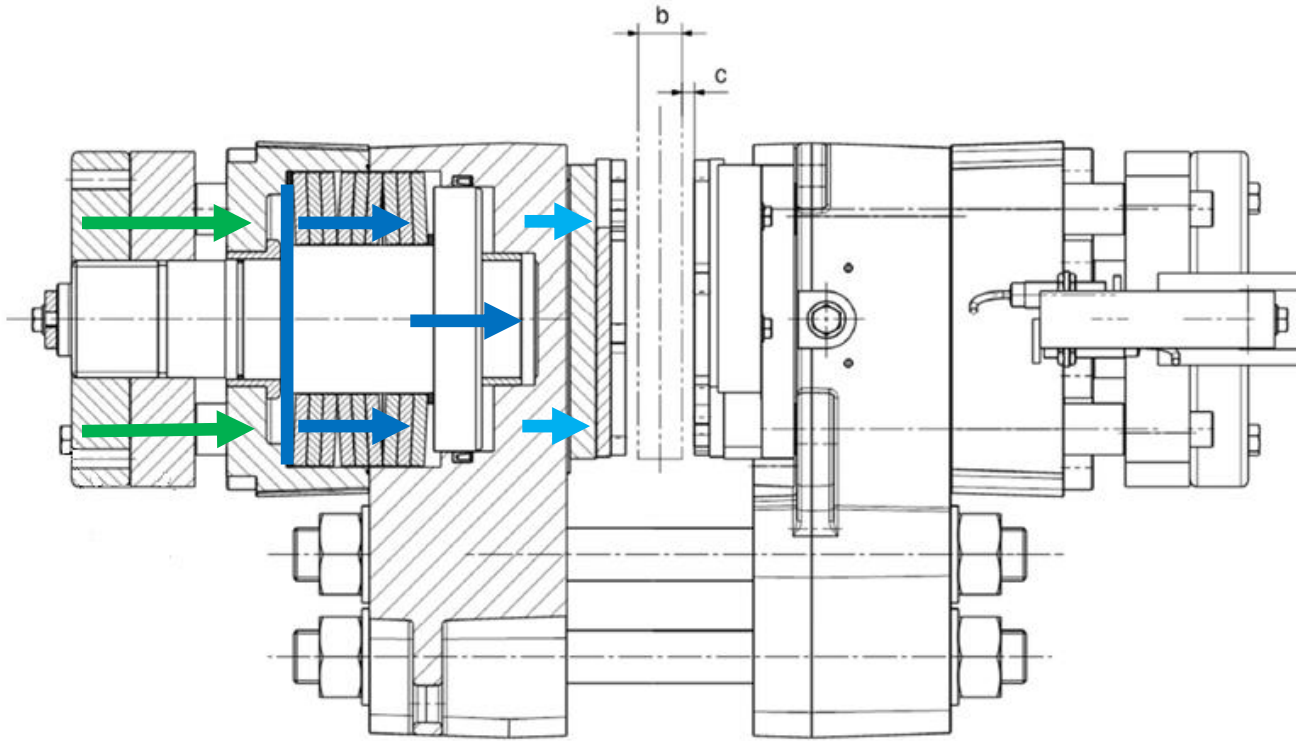

- 1) Extending cup-springs*
- 2) Transmission to piston*
- 3) Transmission to pressure pins*
- 4) Transmission to linings/disc*

## SNAG REACTION VS PREVENTION

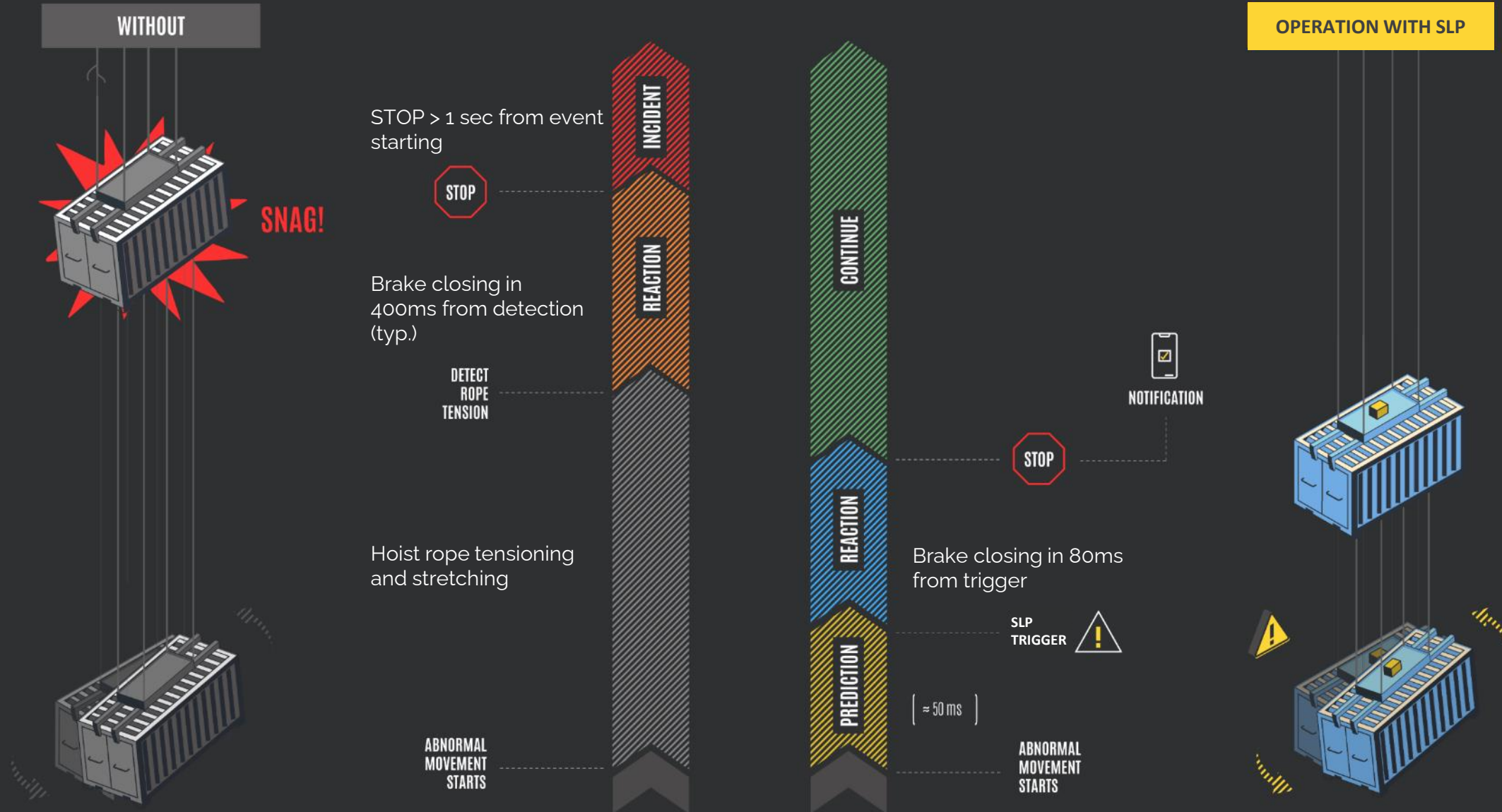



# Maximize your efficiency by

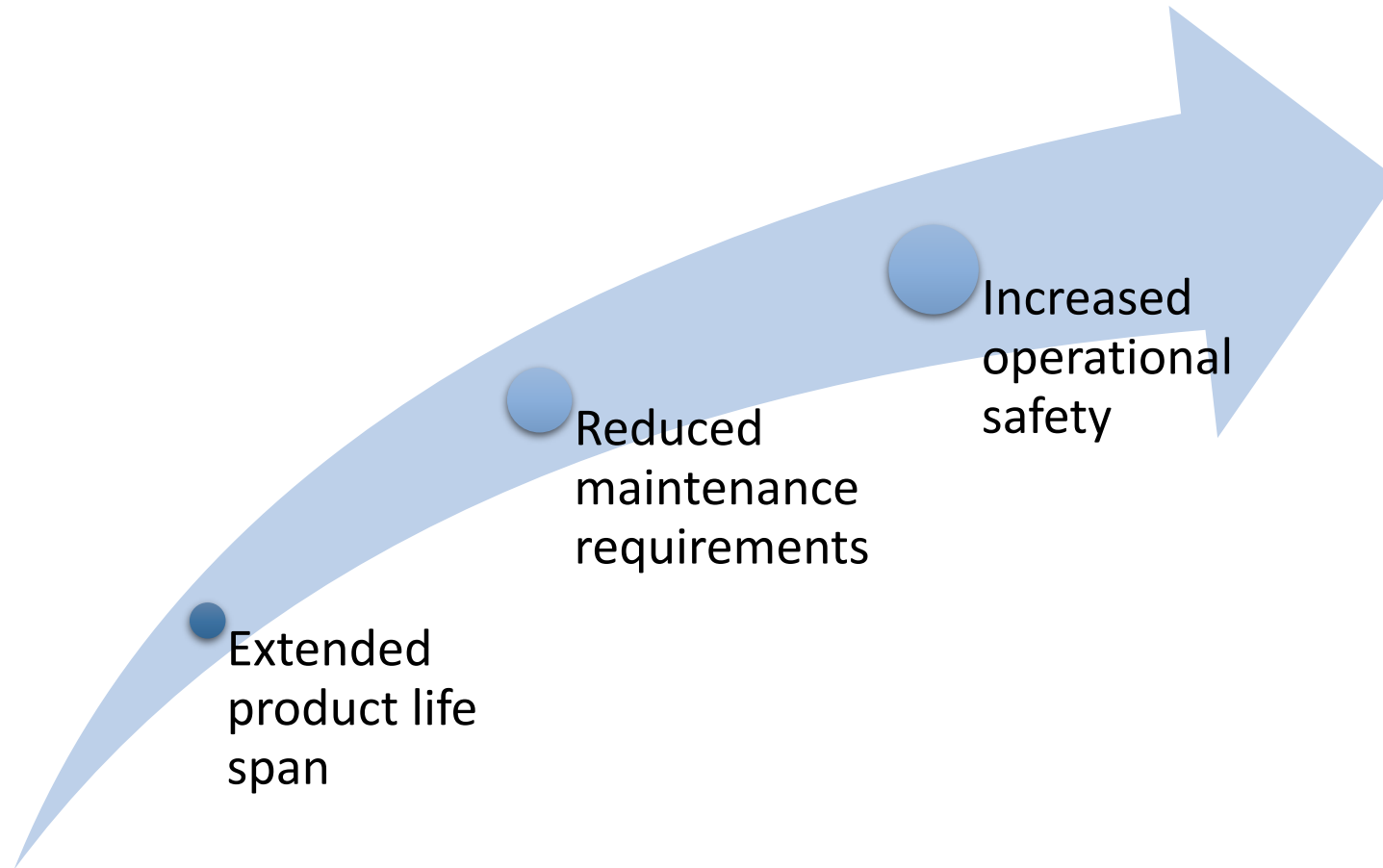



*Sure to be Safe*

Siegerland Bremsen



TRANSPORT  
MIDDLE EAST 2024

# Thank you for your attention!

lb@sibre.de | [www.sibre.de](http://www.sibre.de)

